

SMDA NUMBER
N44-SW102-_____

CLARK 80' R/W AVENUE

BLAINE AVENUE

60' R/W

BLAINE AVENUE

BLAINE AVENUE

60' R/W

LINDEN AVENUE

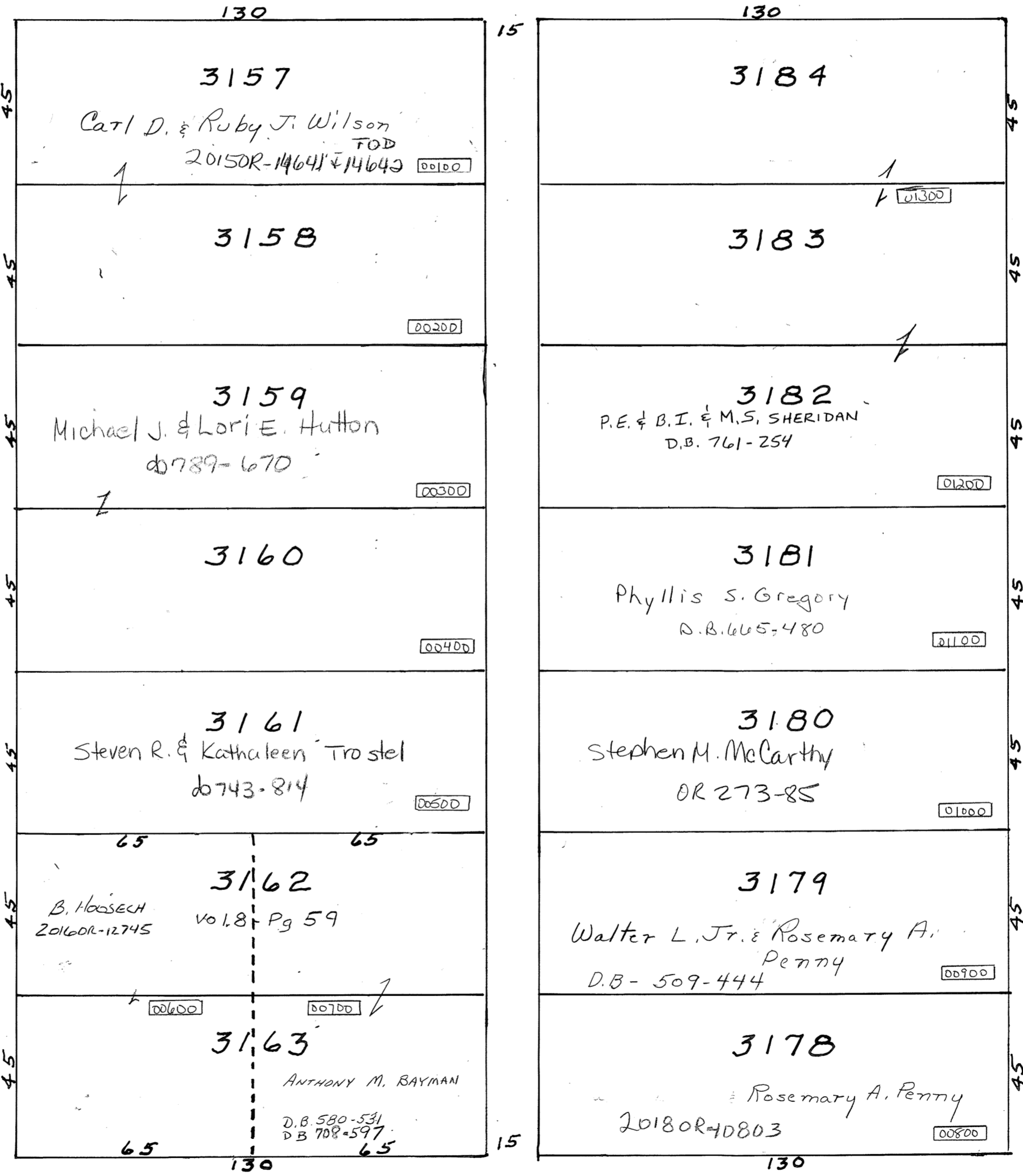

130
45
3157
Carl D. & Ruby J. Wilson
FOD
2015OR-14641 & 14642 00100

45
3158
00200

45
3159
Michael J. & Lori E. Hutton
db789-670 00300

45
3160
00400

45
3161
Steven R. & Kathleen Trostel
db743-814 00500

65 65
45
3162
B. Hoeseck
2016OR-12745 Vol. 18 Pg 59
00600 00700

45
3163
ANTHONY M. BAYMAN
D.B. 580-531
D.B. 708-597
65 65
130

130
45
3184
01300

45
3183
01200

45
3182
P.E. & B.I. & M.S. SHERIDAN
D.B. 761-254 01200

45
3181
Phyllis S. Gregory
D.B. 665-480 01100

45
3180
Stephen M. McCarthy
OR 273-85 01000

45
3179
Walter L. Jr. & Rosemary A. Penny
D.B. 509-444 00900

45
3178
Rosemary A. Penny
2018OR-40803 00800
130

BROOK 50' R/W STREET

Rec. Bk. 2-Pg. 103